

IP Enclosures provide a range of standard Rain Hoods for steel and stainless steel electrical enclosures. All IP Enclosures wall mounted electrical enclosures are manufactured with nutserts to accommodate rain hoods without drilling.

Rain hoods are used to prevent settling and building up of liquids, corrosive solids, minerals, dust, dirt and debris on top of an electrical enclosure. If corrosive liquids and solids settle and build up on top of an enclosure, the integrity of the coating and material may be compromised which may lead to corrosion and ingress of liquids and solids into the enclosure. Without maintenance, this may compromise internal electrical components and could increase risk of electric shock. IP Enclosures rain hoods are easily fitted onto IP Enclosures electrical enclosures. All IP Enclosures electrical enclosures are manufactured with nutserts to accommodate optional rain hoods without drilling to ensure that the IP rating is maintained. Rain hoods are provided with fasteners.

Material:

– Body: 1.2mm-1.5mm Grade 316/316L Stainless Steel.



*Photo indicative sample only.
Refer to the drawing below for the exact dimensions.*

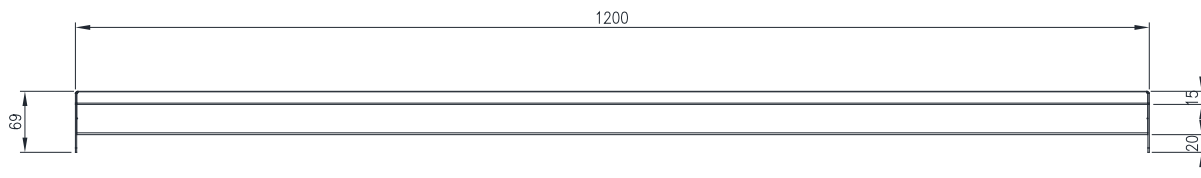
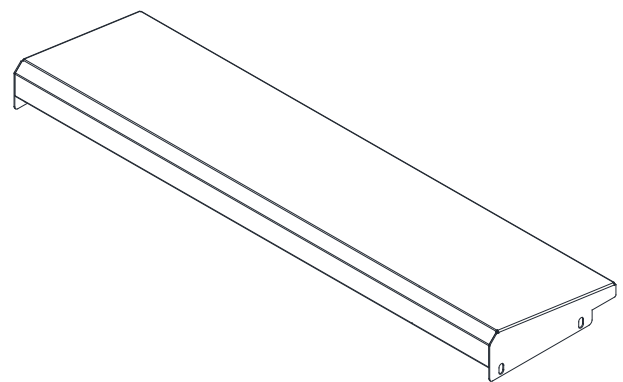

FRONT VIEW

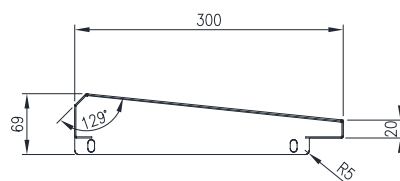

LEFT SIDE VIEW

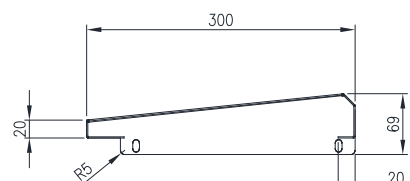

RIGHT SIDE VIEW